

**TECHNICAL MANUAL**

**ORGANIZATIONAL, DIRECT SUPPORT  
AND GENERAL SUPPORT MAINTENANCE  
REPAIR PARTS AND SPECIAL TOOLS LIST  
(INCLUDING DEPOT MAINTENANCE REPAIR  
PARTS AND SPECIAL TOOLS)**

**FOR**

**INTERROGATOR SYSTEM  
TEST SET TS-4095/G  
(NSN 6625-01-178-3878)**

---

**HEADQUARTERS, DEPARTMENT OF THE ARMY  
9 SEPTEMBER 1985**

**1985**

**ORGANIZATIONAL, DIRECT SUPPORT, AND GENERAL SUPPORT MAINTENANCE  
REPAIR PARTS AND SPECIAL TOOLS LIST  
(INCLUDING DEPOT MAINTENANCE REPAIR PARTS AND SPECIAL TOOLS)  
FOR  
INTERROGATOR SYSTEM  
TEST SET TS-4095/G  
(NSN 6625-01-178-3878)**

Current as of 25 March 1985

**REPORTING OF ERRORS AND RECOMMENDING IMPROVEMENTS**

You can help improve this manual. If you find any mistakes or if you know of a way to improve the procedures, please let us know. Mail your letter, DA Form 2028 (Recommended Changes to Publications and Blank Forms), or DA Form 2028-2 located in the back of this manual direct to: Commander, US Army Communications-Electronics Command and Fort Monmouth, ATTN: AMSEL-ME-MP, Fort Monmouth, NJ 07703-5007. A reply will be furnished to you.

**TABLE OF CONTENTS**

		Page	Illus Figure
Section	I. Introduction .....	1	
	II. Repair Parts List .....	1-1	
Group	00 Interrogator System Test Set TS-4095/G .....	1-1	1
	01 Panel Assembly .....	2-1	2
	0101 Circuit Card Assembly A1 .....	3-1	3
	0102 Circuit Card Assembly A2 .....	4-1	4
	0103 Circuit Card Assembly A3 .....	5-1	5
	02 IST/Kit Cable Assembly W1 .....	6-1	6
	03 Power Cable Assembly W2 .....	7-1	7
	04 IST/PPX-3() Cable Assembly W3 .....	8-1	8
	05 IST/GSX-I()Cable Assembly W4 .....	9-1	9
	06 IST/APX-72 Cable AssemblyW5 .....	10-1	10
Section	III. Special Tools List (Not applicable)		
	IV. National Stock Number and Part Number Index.....	I-1	

i/(ii blank)

**SECTION I  
INTRODUCTION**

---

**1. Scope**

This manual lists and authorizes spares and repair parts; special tools: special test, measurement, and diagnostic equipment (TMDE), and other special support equipment required for performance of organizational and direct support of the TS-4095/G. It authorizes the requisitioning, issue, and disposition of spares, repair parts and special tools as indicated by the source, maintenance and recoverability (SMR) codes.

**2. General**

This Repair Parts and Special Tools List is divided into the following sections:

a. *Section II. Repair Parts List.* A list of spares and repair parts authorized by this RPSTL for use in the performance of maintenance. The list also includes parts which must be removed for replacement of the authorized parts. Parts lists are composed of functional groups in ascending numeric sequence, with the parts in each group listed in ascending item number sequence. Figure numbers are listed directly beneath the group header.

b. *Section III. Special Tools List.* Not applicable.

c. *Section IV. National Stock Number and Part Number Index.* A list, in National item identification number (NIIN) sequence, of all National stock numbered items appearing in the listings, followed by a list in alphanumeric sequence of all part numbers appearing in the listings. National stock numbers and part numbers are cross referenced to each illustration figure and item number appearance.

**3. Explanation of Columns (Section II and III)**

a. *Item No. (Column (1)).* Indicates the number used to identify items called out in the illustration.

b. *SMR Code (Column (2)).* The source, maintenance, and recoverability (SMR) code is a five-position code containing supply/requisitioning information, maintenance category authorization criteria, and disposition instruction, as shown in the following breakout:

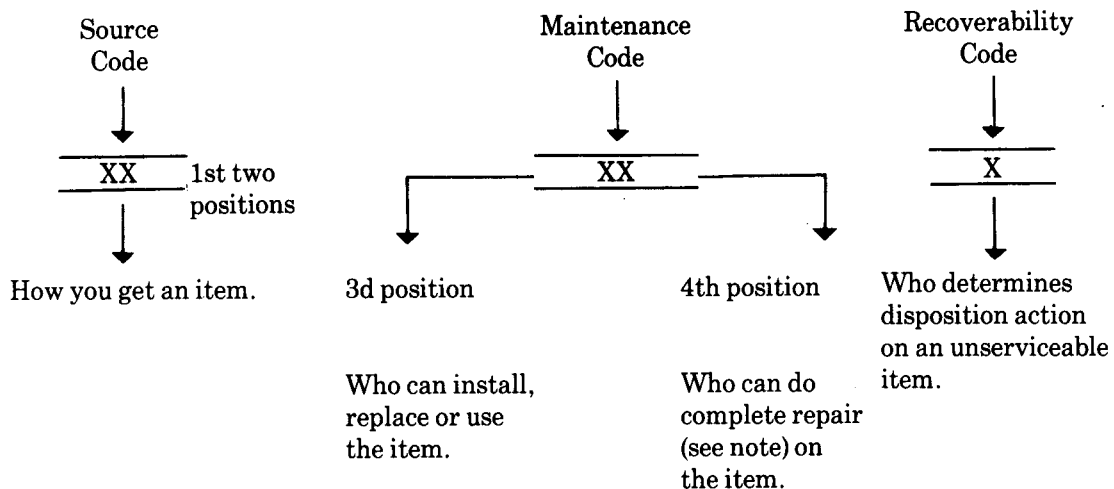

**NOTE**

Complete repair: Maintenance capacity, capability, and authority to perform all corrective maintenance tasks of the "Repair" function in a use/user environment in order to restore serviceability to a failed item.

(1) *Source Code*. The source code tells you how to get an item needed for maintenance, repair, or overhaul of an end item/equipment. Explanations of source codes follows:

*Code*

*Explanation*

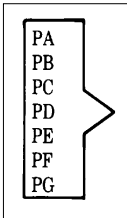

Stocked items; use the applicable NSN to request/requisition items with these source codes. They are authorized to the category indicated by the code entered in the third position of the SMR code.

**NOTE**

Items coded PC are subject to deterioration.

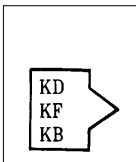

Items with these codes are not to be requested/requisitioned individually. They are part of a kit which is authorized to the maintenance category indicated in the third position of the SMR code. The complete kit must be requisitioned and applied.

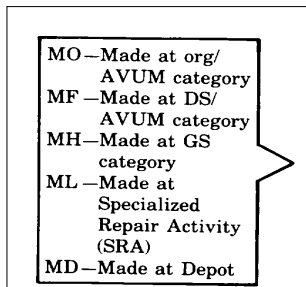

Items with these codes are not to be requested/requisitioned individually. They must be made from bulk material which is identified by the part number in the description and usable on code (UOC) column and listed in the Bulk Material group of the repair parts list. If the item is authorized to you by the third position code of the SMR but the source code indicates it is made at a higher category, order the item from the higher category of maintenance.

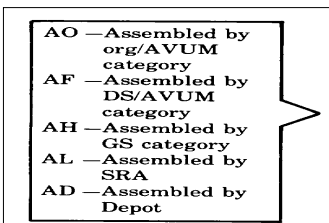

Items with these codes are not to be requested/requisitioned individually. The parts that make up the assembled item must be requisitioned or fabricated and assembled at the category of maintenance indicated by the source code. If the disposition code of the SMR code authorizes you to replace the item, but the source code indicates the item is assembled at a higher category, order the item from the higher category of maintenance.

- XA - Do not requisition an "XA" coded item. Order its next higher assembly.
- XB - If an "XB" item is not available from salvage, order it using the FSCM and part number given.
- XC - Installation drawing, diagram, instruction sheet, field service drawing, that is identified by manufacturers part number.
- XD - Item is not stocked. Order an "XD" coded item through normal supply channels using the FSCM and part number given, if no NSN is available.

**NOTE**

Cannibalization or controlled exchange, when authorized, may be used as a source of supply for items with the above source codes, except for those source coded "XA" or those aircraft support items restricted by requirements of AR 750-1.

(2) *Maintenance Code.* Maintenance codes tell you the category of maintenance authorized to USE and REPAIR support items. The maintenance codes are entered in the third and fourth positions of the SMR code as follows:

(a) The maintenance code entered in the third position tells you the lowest maintenance category authorized to remove, replace, and use an item. The maintenance code entered in the third position will indicate authorization to one of the following categories of maintenance.

<i>Code</i>	<i>Application/Explanation</i>
C -	Crew or operator maintenance done within organizational or aviation maintenance.
O -	Organizational or aviation unit category can remove, replace, and use the item.
F -	Direct support or aviation intermediate category can remove, replace, and use the item.
H -	General support category can remove, replace, and use the item.
L -	Specialized repair activity can remove, replace, and use the item.
D -	Depot category can remove, replace, and use the item.

(b) The maintenance code entered in the fourth position tells whether or not the item is to be repaired and identifies the lowest maintenance category with the capability to do complete repair (i.e., perform all authorized repair functions). This position will contain one of the following maintenance codes:

**NOTE**

Some limited repair may be done on the item at a lower category of maintenance, if authorized by the Maintenance Allocation Chart (MAC) and SMR codes.

Code Application/Explanation

O -	Organizational or aviation unit is the lowest category that can do complete repair of the item.
F -	Direct support or aviation intermediate is the lowest category that can do complete repair of the item.
H -	General support is the lowest category that can do complete repair of the item.
L -	Specialized repair activity (designate the specialized repair activity) is the lowest category that can do complete repair of the item.
D -	Depot is the lowest category that can do complete repair of the item.
Z -	Nonreparable. No repair is authorized.
B -	No repair is authorized. (No parts or special tools are authorized for the maintenance of a "B" coded item.) However, the item may be reconditioned by adjusting, lubricating, etc., at the user category.

(3) *Recoverability Code.* Recoverability codes are assigned to items to indicate the disposition action on unserviceable items. The recoverability code is entered in the fifth position of the SMR Code as follows:

*Recoverability  
codes*

*Application/Explanation*

- Z - Nonreparable item. When unserviceable, condemn and dispose of the item at the category of maintenance shown in the third position of SMR Code.
- O - Reparable item. When uneconomically reparable, condemn and dispose of the item at organizational or aviation unit category.
- F - Reparable item. When uneconomically reparable, condemn and dispose of the item at the direct support or aviation intermediate category.
- H - Reparable item. When uneconomically reparable, condemn and dispose of the item at general support category.
- D - Reparable item. When beyond lower level repair capability, return to depot. Condemnation and disposal of item not authorized below depot category.
- L - Reparable item. Condemnation and disposal not authorized below specialized repair activity (SRA).
- A - Item requires special handling or condemnation procedures because of specific reasons (e.g., precious metal content, high dollar value, critical material, or hazardous material). Refer to appropriate manuals/directives for specific instructions.

c. *FSCM (Column (3))*. The Federal Supply Code for Manufacturer (FSCM) is a 5-digit numeric code which is used to identify the manufacturer, distributor, or Government agency, etc., that supplies the item.

d. *Part Number (Column (4))*. Indicates the primary number used by the manufacturer (individual, company, firm, corporation, or Government activity), which controls the design and characteristics of the item by means of its engineering drawings, specifications, standards, and inspection requirements to identify an item or range of items.

**NOTE**

When you use a NSN to requisition an item, the item you receive may have a different part number from the part ordered.

e. *Description and Usable on Code (UOC)(Column (5))*. This column includes the following information.

(1) The Federal item name and, when required, a minimum description to identify the item.

(2) The statement "END OF FIGURE" appears just below the last item description in Column (5) for a given figure in both section II and section III.

f. *Qty (Column (6))*. Indicates the quantity of the item used in the breakout shown on the illustration figure, which is prepared for a functional group, subfunctional group, or an assembly. A "V" appearing in this column in lieu of a quantity indicates that the quantity is variable and the quantity may vary from application to application.

**4. Explanation of Columns (Section IV)**

a. *National Stock Number (NSN) Index*.

(1) *Stock number column*. This column lists the NSN by National item identification number (NIIN) sequence. The NIIN consists of the last nine digits of the NSN. When using this column to locate an item, ignore the first four digits of the NSN. When requisitioning items use the complete NSN (13 digits).

(2) *Fig. column*. This column lists the number of the figure where the item is identified/located. The illustrations are in numerical sequence in sections 11 and III.

(3) *Item column.* The item number identifies the item associated with the figure listed in the adjacent Fig. column. This item is also identified by the NSN listed on the same line.

b. *Part Number Index.* Part numbers in this index are listed by part number in ascending alphameric sequence.

(1) *FSCM column.* This column lists the Federal supply code for manufacturer (FSCM).

(2) *Part number column.* This column indicates the part number assigned to the item.

(3) *Stock number column.* This column lists the National stock number for the associated part number and manufacturer identified in the part number and FSCM columns to the left.

(4) *Fig. column.* This column lists the number of the figure where the item is identified/located in sections II and III.

(5) *Item column.* The item number is that number assigned to the item as it appears in the figure referenced in the adjacent figure number column.

## 5. Special Information

a. *Associated Publications.* The publications listed below pertain to the TS-4095/G and its components:

TM 11-5895-1194-24, IFF Interrogator Kit AN/PPX-3A and AN/PPX-3B, Interrogator Set Programmer AN/GSX-1 and AN/GSX-1A

TM 11-5895-1194-40&P-3, Interrogator System Test Set TS-4095/G

b. *National Stock Numbers.* National stock numbers (NSN's) that are missing from P source coded items have been applied for and will be added to this TM by future change/revision when they are entered in the Army Master Data File (AMDF). Until the NSN's are established and published, submit exception requisitions to: Commander, US Army Communications-Electronics Command and Fort Monmouth, ATTN: AMSEL-MM, Fort Monmouth, NJ 07703-5006 for the part required to support your equipment.

## 6. How to Locate Repair Parts

a. *When National stock number or part number is not known.*

(1) *First.* Using the table of contents, determine the assembly group or subassembly group to which the item belongs. This is necessary since figures are prepared for assembly groups and subassembly, and listings are divided into the same groups.

(2) *Second.* Find the figure covering the assembly group or subassembly group to which the item belong.

(3) *Third.* Identify the item on the figure and not the item number.

(4) *Fourth.* Refer to the Repair Parts List for the figure to find the part number for the item number noted on the figure.

(5) *Fifth.* Refer to the Part Number Index to find the NSN, if assigned.

*b. When National stock number or part number is known.*

(1) *First.* Using the Index of National stock numbers and part numbers, find the pertinent National stock number or part number. The NSN index is in National item identification number (NIIN) sequence (para 4a(1)). The part numbers in the part number index are listed in ascending alphameric sequence (para 4b). Both indexes cross-reference you to the illustration figure and item number of the item you are looking for.

(2) *Second.* After finding the figure and item number, verify that the item is the one you're looking for, then locate the item number in the repair parts list for the figure.

## **7. Abbreviations**

Not applicable.



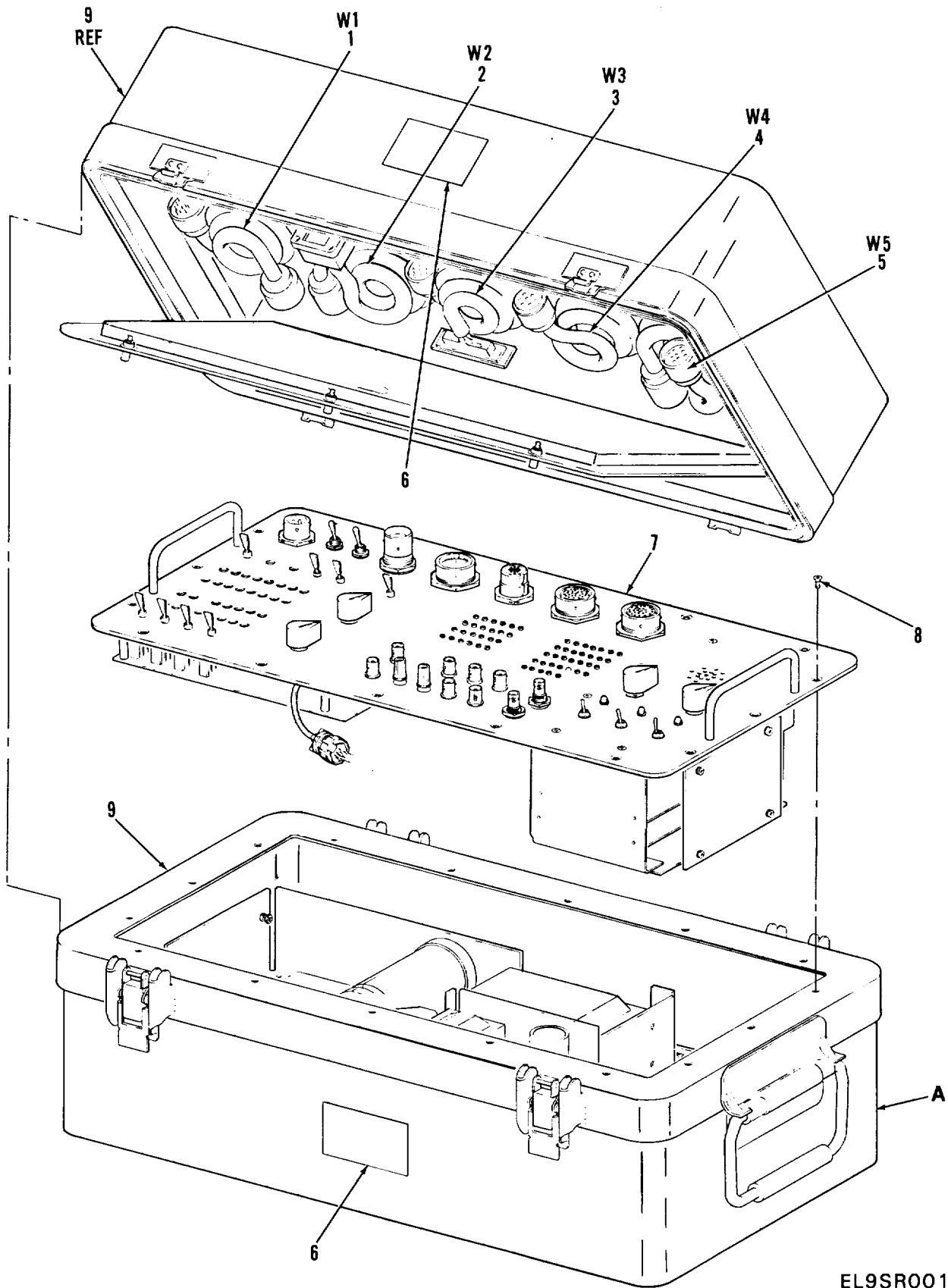

EL9SR001

Figure 1. Interrogator System Test Set TS-4095/G (Sheet 1 of 2)

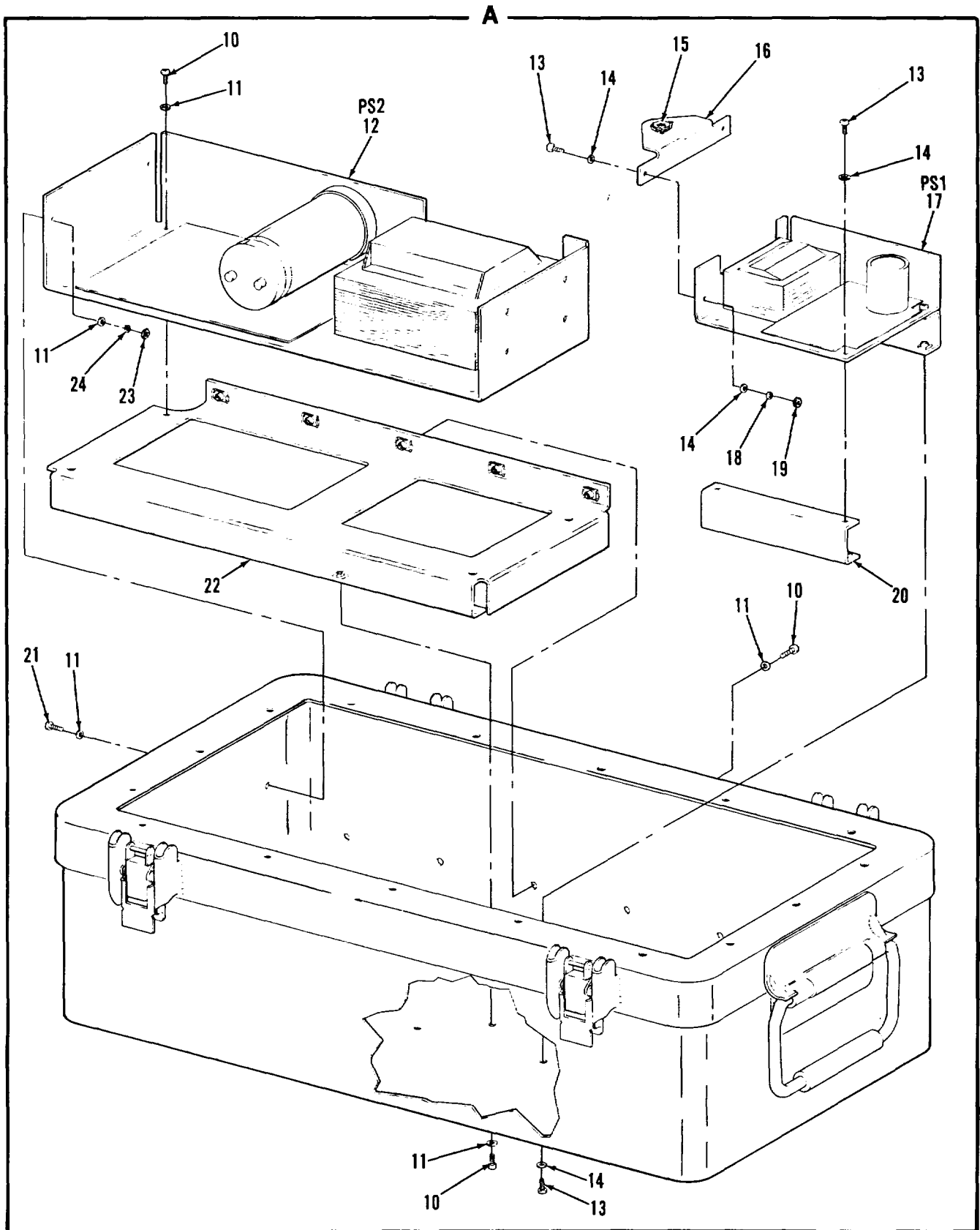

EL9SR002

Figure 1. Interrogator System Test Set TS-4095/G (Sheet 2 of 2)

## SECTION II

TM 11-5895-1194-24P-3

(1) ITEM NO	(2) SMR CODE	(3) CAGEC	(4) PART NUMBER	(5) DESCRIPTION AND USABLE ON CODES (UOC)	(6) QTY
-------------------	--------------------	--------------	-----------------------	--	------------

GROUP 00 INTERROGATOR SYSTEM TEST  
SET TS-4095/G  
FIG.1

1	PAHDD	45413	157119	CABLE,ASSEMBLY W1 .....	1
2	PAHDD	18876	11509861	CABLE ASSEMBLY,POWE N2 .....	1
3	PAHDD	45413	157121	CABLE,ASSEMBLY W3 .....	1
4	PAHDD	45413	157122	CABLE,ASSEMBLY W4 .....	1
5	PAHDD	45413	157120	CABLE,ASSEMBLY WN5 .....	1
6	XBHZZ	45413	157420	PLATE,IDENT .....	2
7	XBHLL	45413	156412	PANEL ASSY .....	1
8	PAHZZ	96906	MS24693-272B	SCREW,MACHINE .....	16
9	XBHZZ	45413	156187	CASE .....	1
10	PAHZZ	96906	MS51957-45	SCREW,MACHINE .....	14
11	PAHZZ	96906	M515795-807	WASHER,FLAT .....	18
12	PAHZZ	54407	HE28-6	PLIER SUPPLY PS2 .....	1
13	PAHZZ	96906	MS51957-30	SCREW,MACHINE .....	10
14	PAHZZ	96906	MS15795-805	WASHER,FLAT .....	12
15	PAHZZ	02660	126-221	COINECTOR,RECEPTACL .....	1
16	XBHZZ	45413	156404	BRICKET,CONNECTOR .....	1
17	PAHZZ	54407	B15-1.5	CURRENT-VOLTAGE STA PS1 .....	1
18	PAHZZ	96906	M535338-136	WASHER,LOCK .....	2
19	PAHZZ	96906	M535649-264	NUT,PLAIN,HEXAGON .....	2
20	XBHZZ	45413	156402	BRACKET,PWR SUPPLY .....	2
21	PAHZZ	96906	M551957-46	SCREW,MACHINE .....	2
22	XBHZZ	45413	156405	BRACKET,PWR SUPPLY .....	1
23	PAHZZ	96906	MS35649-284	NUT,PLAIN,HEXAGON .....	2
24	PAHZZ	96906	M535338-137	WASHER,LOCK .....	2

END OF FIGURE

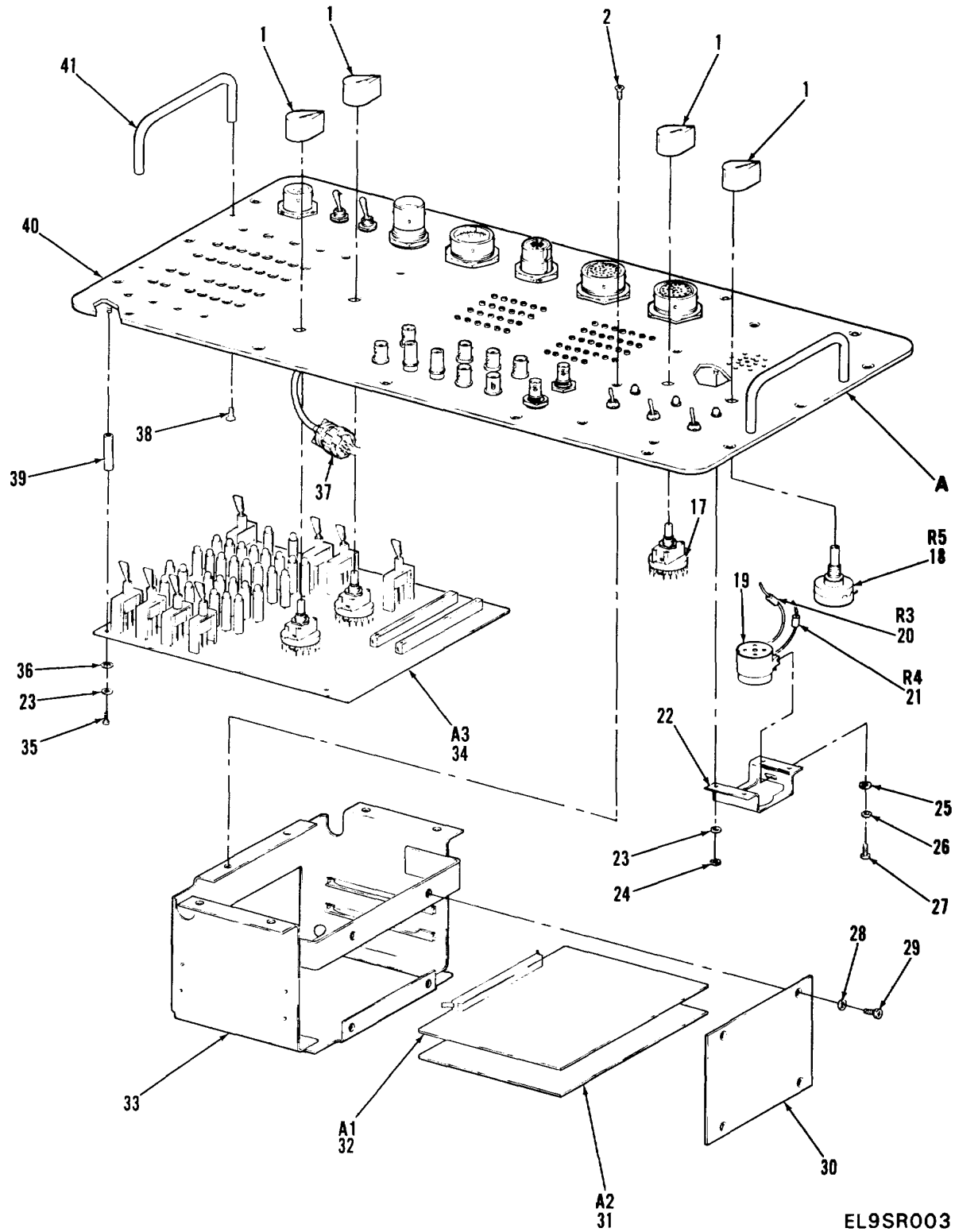
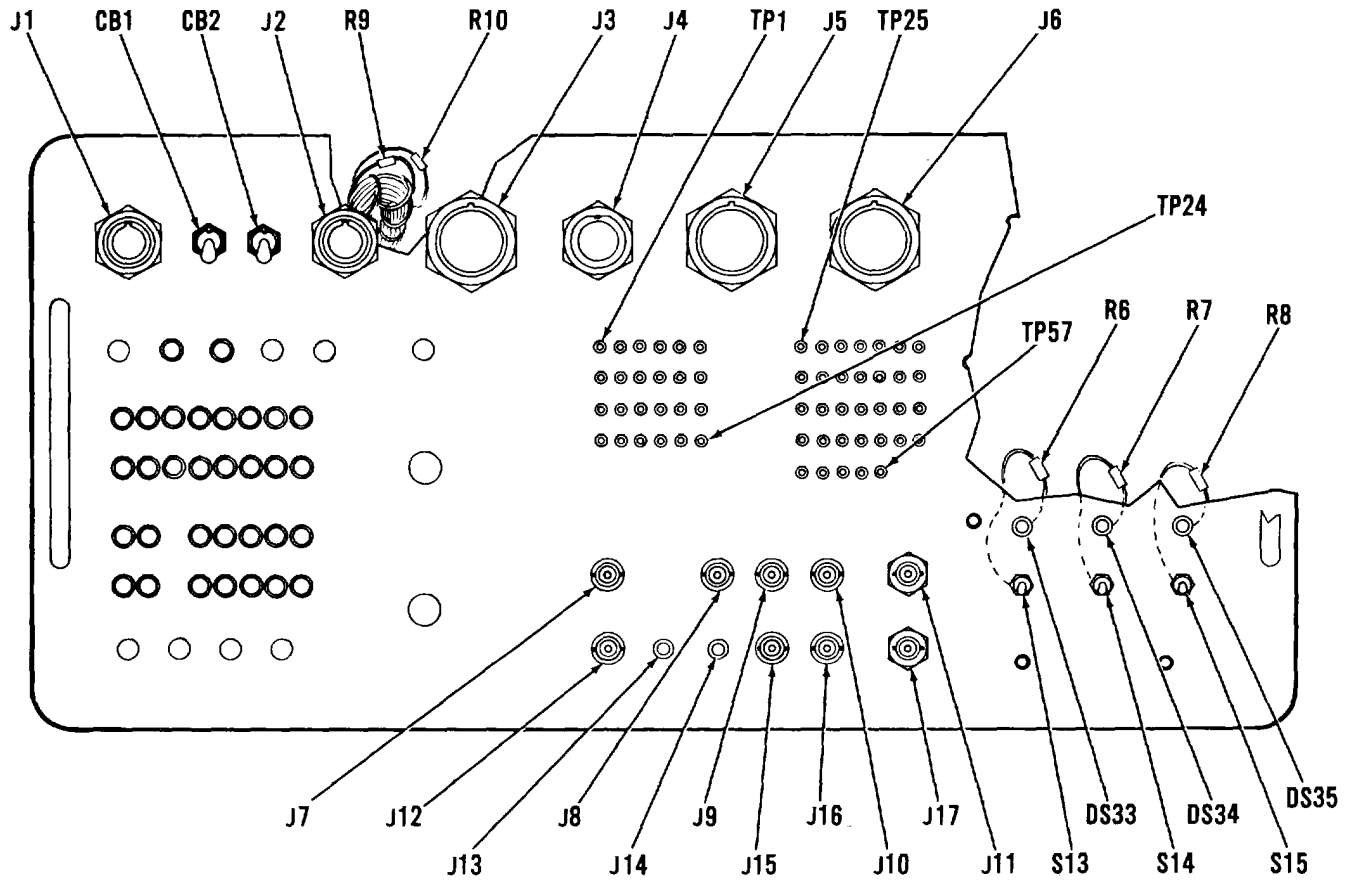

Figure 2. Panel Assembly (Sheet 1 of 2)

EL9SR003



REF DES	ITEM NO.	REF DES	ITEM NO.
CB1	3	J15	9
CB2	3	J16	9
DS33	4	J17	10
DS34	4	R6	13
DS35	4	R7	13
J1	5	R8	13
J2	6	R9	14
J3	7	R10	14
J4	8	S13	15
J5	7	S14	15
J6	7	S15	15
J7	9	TP1	16
J8	9	thru	
J9	9	TP57	
J10	9		
J11	10		
J12	9		
J13	11		
J14	12		

EL9SR004

Figure 2. Panel Assembly (Sheet 2 of 2)

## SECTION II

TM 11-5895-1194-24P-3

(1) ITEM NO	(2) SMR CODE	(3) CAGEC	(4) PART NUMBER	(5) DESCRIPTION AND USABLE ON CODES (UOC)	(6) QTY
GROUP 01 PANEL ASSEMBLY FIG. 2					
1	PAHZZ	96906	MS91528-1U2B	KNOB.....	4
2	PAHZZ	96906	MS24693C278	SCREW,MACHINE .....	6
3	PAHZZ	81349	M439019/01-28	CIRCUIT BREAKER .....	2
4	PAHZZ	72619	559-0101-001	LIGHT,INDICATOR .....	3
5	PAHZZ	96906	MS3124E12-3P	CONNECTOR,RECEPTACL .....	1
6	PAHZZ	98278	MD6312E561SP	CONNECTOR .....	1
7	PAHZZ	96906	MS3474L18-32PW	CONNECTOR,RECEPTACL .....	3
8	PAHZZ	18876	MIS-23393-007	CONNECTOR SET.ELECT .....	1
9	PAHZZ	81349	M39012/21-0001	CONNECT.R,RECEPTACL .....	7
10	PAHZZ	81349	M39012/19-0502	CONNECTOR,RECEPTACL .....	2
11	PAHZZ	74970	111-202-052	POST,BINDING(RED) .....	1
12	PAHZZ	74970	111-0743-002	POST,BINDING(BLK) .....	1
13	PAHZZ	81349	RCR07G1S2JS	RESISTOR,FIXED,COMP .....	3
14	PAHZZ	81349	RCR7G1OJS	RESISTOR,FIXED,COMP .....	2
15	PAHZZ	96906	M575028-23	SWITCH,TOGGLE , .....	3
16	PAHZZ	98291	016 -2008	JACK,TEST POINT .....	57
17	PAHZZ	76854	399287-AM	SWITCH,ROTARY .....	1
18	PAHZZ	446855	CU1011-100	RESISTOR,VARIABLE .....	1
19	PAHZZ	18876	MIS-23408	LOUDSPEAKER,PERMANE .....	1
20	PAHZZ	81349	RCR32G390JS	RESISTOR,FIXED,COMP .....	1
21	PAHZZ	81349	RCR32G6R8JS	RESISTOR,FIXED,COMP .....	1
22	XBHZZ	45413	156403	BRACKET ,SPEAKER .....	1
23	PAHZZ	96906	MS35338-135	WASHER,LOCK .....	8
24	PAHZZ	96906	MS35649-244	NUT,PLAIN,HEXAGON .....	4
25	PAHZZ	96906	MS15795-802	WASHER,FLAT .....	2
26	PAHZZ	96906	MS35338-134	WASHER,LOCK .....	2
27	PAHZZ	96906	MS5 1957-2	SCREW,MACHINE .....	2
28	PAHZZ	96906	MS15795-805	WASHER,FLAT .....	4
29	PAHZZ	96906	MS51957-29	SCREW,MACHINE .....	4
30	XBHZZ	45413	156242	COVER ASSY, CD RK.....	1
31	PBHLL	45413	156484	CIRCUIT CARD ASSY A2 .....	1
32	PBHLL	45413	156483	CIRCUIT CARD ASSY. A1 .....	1
33	XBHZZ	45413	156127	CARD RACK ASSY .....	1
34	PBHLL	45413	156485	CIRCUIT CARD ASSY A3 .....	1
35	PAHZZ	96906	M551 957-13	SCREW,MACHINE .....	4
36	PAHZZ	96906	MS15795-803	WASHER,FLAT .....	4
37	PAHZZ	026U60	MS12765-220	CONNECTOR,PLUG,ELEC .....	1
38	PAHZZ	96906	M524693C47	SCREW,MACHINE .....	4
39	PAHZZ	06540	8161-SS-0470	POST,ELECTRICAL-MEC .....	4
40	XAHZZ	45413	156406	PANEL .....	1
-41	XBH	06540	13213-SS-0832	HANDLE .....	2
END OF FIGURE					

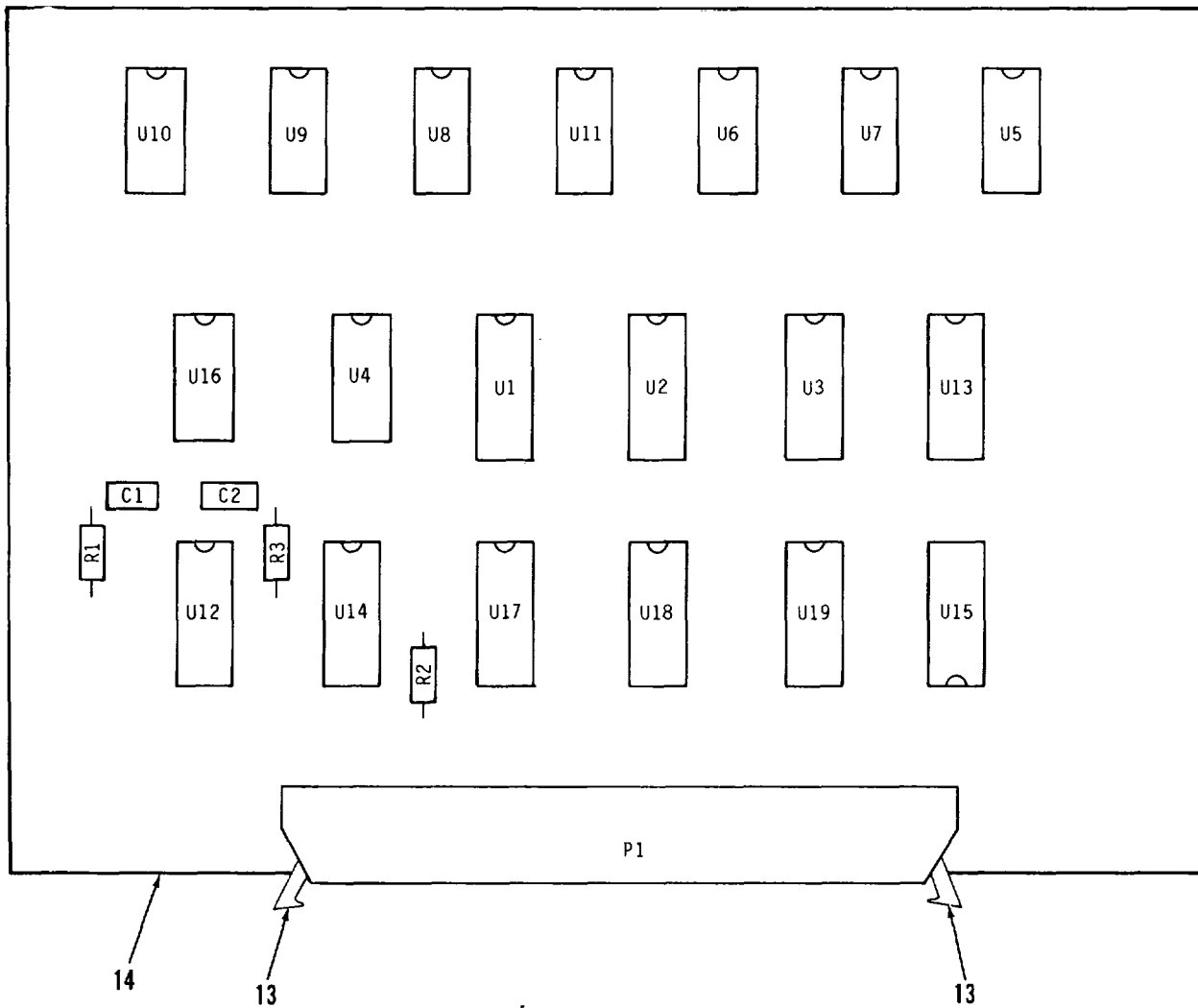

REF DES	ITEM NO.	REF DES	ITEM NO.
C1	1	U13	6
C2	1	U14	6
P1	2	U15	6
R1	3	U16	10
R2	3	U17	11
R3	4	U18	12
U1	5	U19	12
U2	5		
U3	6		
U4	7		
U5	8		
U6	8		
U7	8		
U8	8		
U9	8		
U10	8		
U11	8		
U12	9		

EL9SR005

Figure 3. Circuit Card Assembly A1

## SECTION II

TM 11-5895-1194-24P-3

(1) ITEM NO	(2) SMR CODE	(3) CAGEC CAGEC	(4) PART NUMBER	(5) DESCRIPTION AND USABLE ON CODES (UOC)	(6) QTY
-------------------	--------------------	-----------------------	-----------------------	--	------------

## GROUP 0101 CIRCUIT CARD ASSEMBLY

A1

FIG. 3

1	PAZZ	81349	M39014/01-1324	CAPACITOR, FIXED, CER .....	2
2	PAZZ	00779	102160-1	CONNECTOR .....	1
3	PAZZ	81349	RCROSGIO5JS	RESISTOR, FIXED, COMP .....	2
4	PAZZ	81349	RCROSG223JS	RESISTOR, FIXED, COMP .....	1
5	PAZZ	02735	CD4050BF/3	MICROCIRCUIT, DIGITA .....	2
6	PAZZ	81349	M38510/05503BEB	MICROCIRCUIT, DIGITA .....	4
7	PAZZ	0273S	CDOIO1BF/3	MICROCIRCUIT, DIGITA .....	1
8	PAZZ	11627	SCD 11337	MICROCIRCUIT, DIGITA .....	7
9	PAZZ	02735	CD4098BF3	MICROCIRCUIT, DIGITA .....	1
10	PAZZ	81349	M38510/17001BCB	MICROCIRCUIT, DIGITA .....	1
11	PAZZ	81349	M8340102K1004GB	RESISTOR NETWORK, F! .....	1
12	PAZZ	91637	MDP1603-681G	RESISTOR NETWORK .....	2
13	PAZZ	00779	102185-2	LATCH LOCK: NG, ELECT .....	2
14	XAZZ	45413	156602	BOARD, PW .....	1
END OF FIGURE					



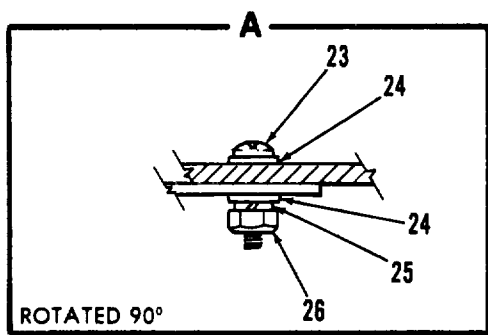
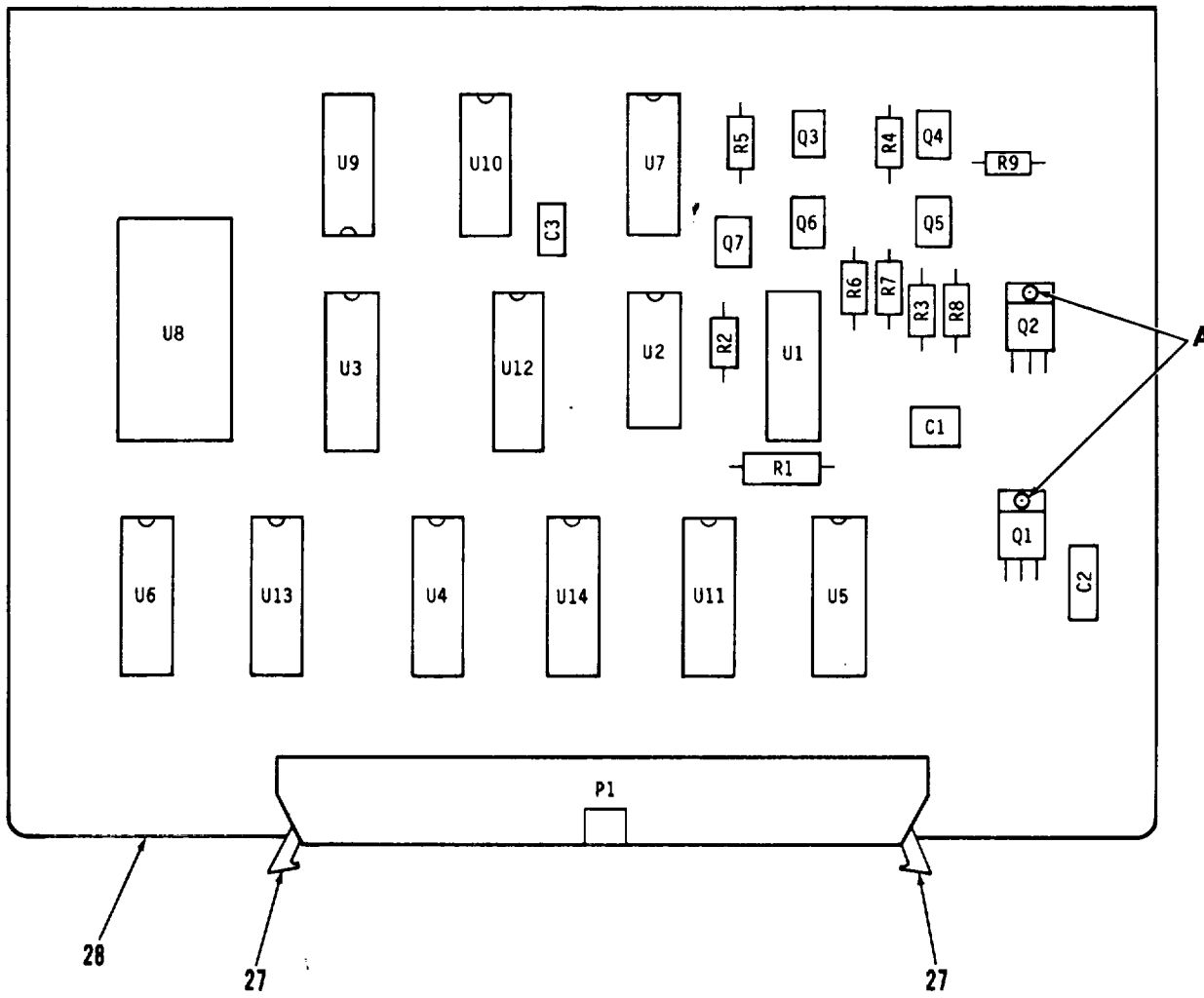

REF DES	ITEM NO.	REF DES	ITEM NO.	REF DES	ITEM NO.
C1	1	Q3	13	U12	21
C2	2	Q4	13	U13	22
C3	3	Q5	13	U14	22
P1	4	Q6	13		
R1	5	Q7	13		
R2	6	U1	14		
R3	7	U2	15		
R4	7	U3	14		
R5	7	U4	16		
R6	7	U5	14		
R7	8	U6	16		
R8	9	U7	17		
R9	10	U8	18		
Q1	11	U9	19		
Q2	12	U10	20		
		U11	16		

EL9SR006

Figure 4. Circuit Card Assembly A2

## SECTION II

TM 11-5895-1194-24P-3

(1) ITEM NO	(2) SMR CODE	(3) CAGEC CAGEC	(4) PART NUMBER	(5) DESCRIPTION AND USABLE ON CODES (UOC)	(6) QTY
				GROUP 0102 A2 FIG. 4	
1	PAHZZ	81349	M39014/02-1358	CAPACITOR, FIXED, CER .....	1
2	PAHZZ	81349	M39014/01-1593	CAPACITOR, FIXED, CER .....	1
3	PAHZZ	81349	M39014/01-1580	CAPACITOR, FIXED, CER .....	1
4	PAHZZ	00779	102160-1	CONNECTOR . .....	1
5	PAHZZ	81349	RCR20G751JS	RESISTOR, FIXED, COMP .....	1
6	PAHZZ	81349	RCR07G123JS	RESISTOR, FIXED, COMP .....	1
7	PAHZZ	81349	RCR07G681JS	RESISTOR, FIXED, COMP .....	4
8	PAHZZ	81349	RNR55C2551FS	RESISTOR FIXED FILM .....	1
9	PAHZZ	81349	RCR07G241JS	RESISTOR, FIXED, COMP .....	1
10	PAHZZ	81349	RCR07G562JS	RESISTOR, FIXED, COMP .....	1
11	PAHZZ	04713	MC7812CT	MICROCIRCUIT, DIGITA .....	1
12	PAHZZ	27014	LM317	REGULATOR .....	1
13	PAHZZ	15737	FD110	MOSFET .....	5
14	PAHZZ	02735	CD4050BF/3	MICROCIRCUIT, DIGITA .....	3
15	PAHZZ	02735	CD4011BD/3	MICROCIRCUIT, DIGITA .....	1
16	PAHZZ	81349	M38510/05503BEB	MICROCIRCUIT, DIGITA ; .....	3
17	PAHZZ	02735	CD4071BF	MICROCIRCUIT, DIGITA .....	1
18	PAHZZ	04713	MC14514B	MICROCIRCUIT .....	1
19	PAHZZ	02735	CD4024BF	MICROCIRCUIT, DIGITA .....	1
20	PAHZZ	02735	CD4013BF	MICROCIRCUIT, DIGITA .....	1
21	PAHZZ	91637	MDP1601-105G	RESISTOR NETWORK .....	1
22	PAHZZ	91637	MDP1603-681G	RESISTOR NETWORK .....	2
23	PAHZZ	96906	MS51957-14	SCREW, MACHINE .....	2
24	PAHZZ	80205	NAS620C4	WASHER, FLAT .....	4
25	PAHZZ	96906	M535338-135	WASHER, LOCK .....	2
26	PAHZZ	96906	MS35649-244	NUT, PLAIN, HEXAGON .....	2
27	PAHZZ	00779	102185-2	LATCH LOCKING, ELECT .....	2
28	XAHZZ	45413	156603	BOARD, PW .....	1
				END OF FIGURE	

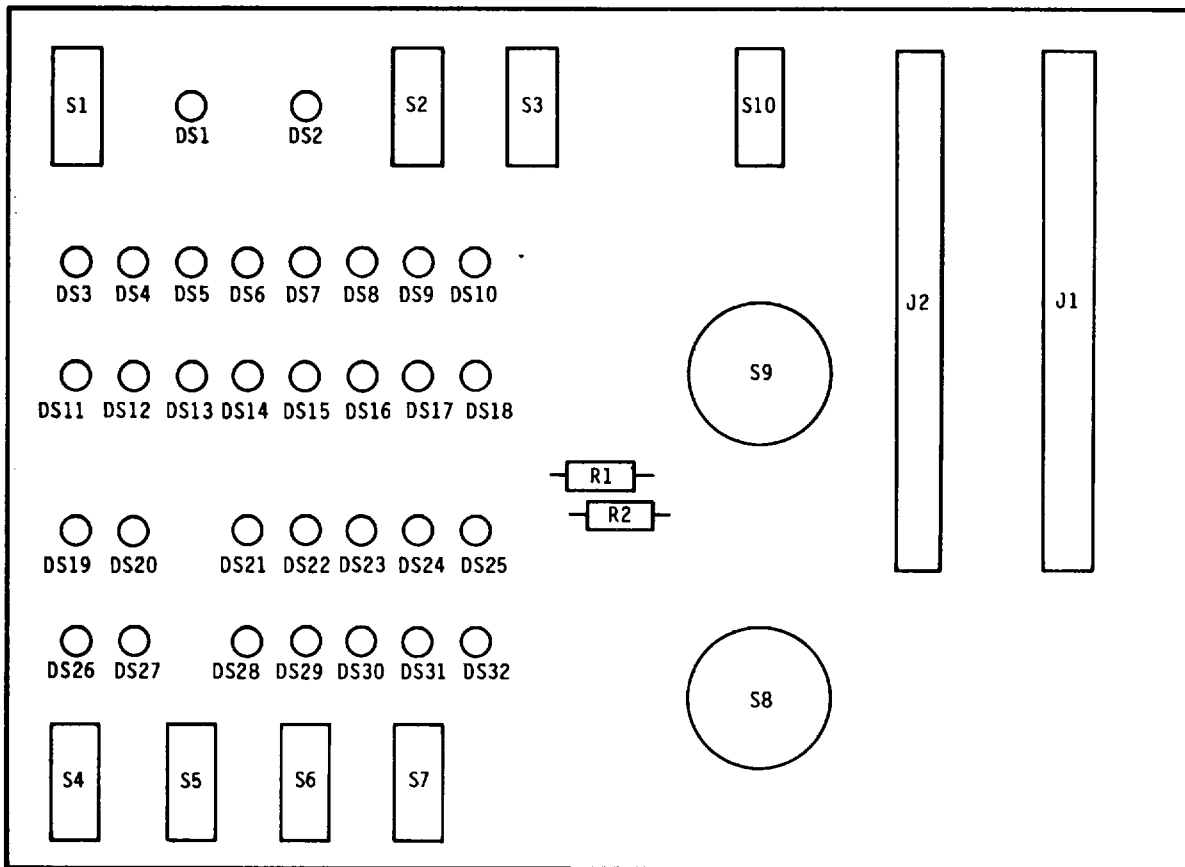

REF DES	ITEM NO.	REF DES	ITEM NO.	REF DES	ITEM NO.
DS1	1	DS30	1		
DS2	1	DS31	1		
DS3	1	DS32	1		
DS4	1	J1	2		
DS5	1	J2	2		
DS6	1	R1	3		
DS7	1	R2	3		
DS8	1	S1	4		
DS9	1	S2	4		
DS10	1	S3	4		
DS11	1	S4	4		
DS12	1	S5	4		
DS13	1	S6	4		
DS14	1	S7	5		
DS15	1	S8	6		
DS16	1	S9	7		
DS17	1	S10	4		
DS18	1				
DS19	1				
DS20	1				
DS21	1				
DS22	1				
DS23	1				
DS24	1				
DS25	1				
DS26	1				
DS27	1				
DS28	1				
DS29	1				

EL9SR007

Figure 5. Circuit Card Assembly A3

## SECTION II

TM 11-5895-1194-24P-3

(1) ITEM NO	(2) SMR CODE	(3) CAGEC CAGEC	(4) PART NUMBER	(5) DESCRIPTION AND USABLE ON CODES (UOC)	(6) QTY
-------------------	--------------------	-----------------------	-----------------------	--	------------

GROUP 0103 CIRCUIT CARD ASSEMBLY

A3

FIG. 5

1	PAHZZ	72619	561-0101-100	LIGHT EMITTING DIOD .....	32
2	PAHZZ	00779	102154-1	CONNECTOR . .....	2
3	PAHZZ	81349	RWR89S1RBOFS	RESISTOR, FIXED, WIRE .....	2
4	PAHZZ	96906	MS75028-23	SWITCH, TOGGLE .....	7
5	PAHZZ	81349	M83731/7-261	SWITCH, TOGGLE .....	1
6	PAHZZ	76854	399049-AM	SWITCH, ROTARY .....	1
7	PAHZZ	76854	399053-AM	SWITCH, ROTARY .....	1
8	XAHZZ	45413	156604	BOARD, PW .....	1

END OF FIGURE

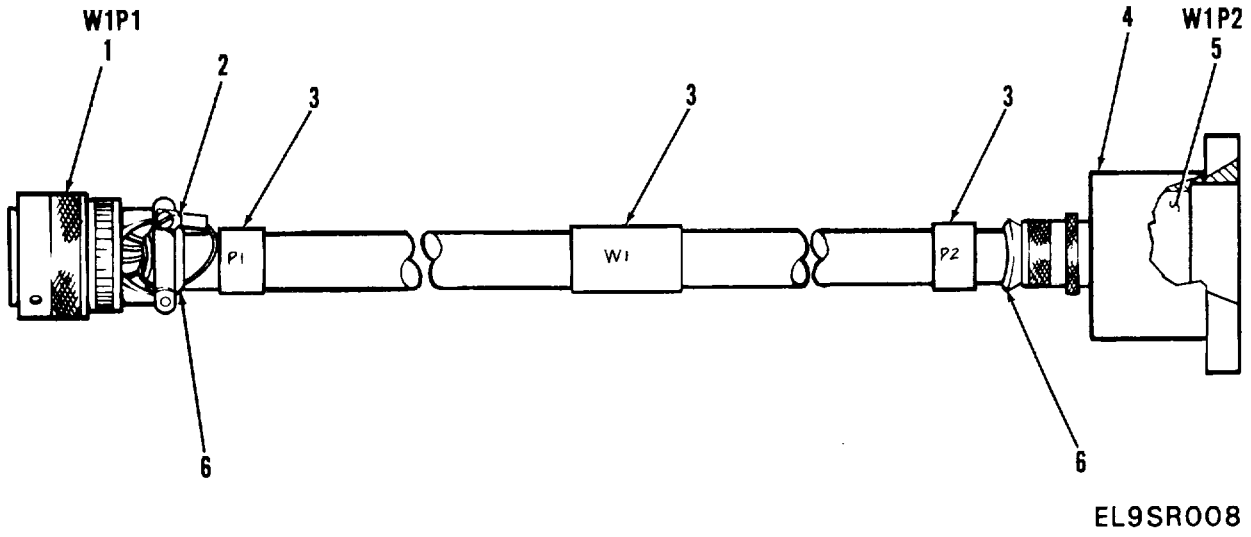

Figure 6. IST/Kit Cable Assembly W1

## SECTION II

TM 11-5895-1194-24P-3

(1) ITEM NO	(2) SMR CODE	(3) CAGEC CAGEC	(4) PART NUMBER	(5) DESCRIPTION AND USABLE ON CODES (UOC)	(6) QTY
-------------------	--------------------	-----------------------	-----------------------	--	------------

GROUP 02 IST/KIT CABLE ASSEMBLY

W1

FIG. 6

1	PADZZ	96906	MS3126E18-32PN	CONNECTOR .....	1
2	PADZZ	79963	5014-097-11	STUD .....	1
3	PADZZ	81349	M23053/5-108-3	INSULATION SLEEVING .....	V
4	PADZZ	45413	154279	CONNECTOR, BACKSHELL .....	1
5	PADZZ	45413	154273	CONNECTOR, PLUG, ELEC .....	1
6	PADZZ	96906	M53420-6	BUSHING, RUBBER.....	2

END OF FIGURE

6-1

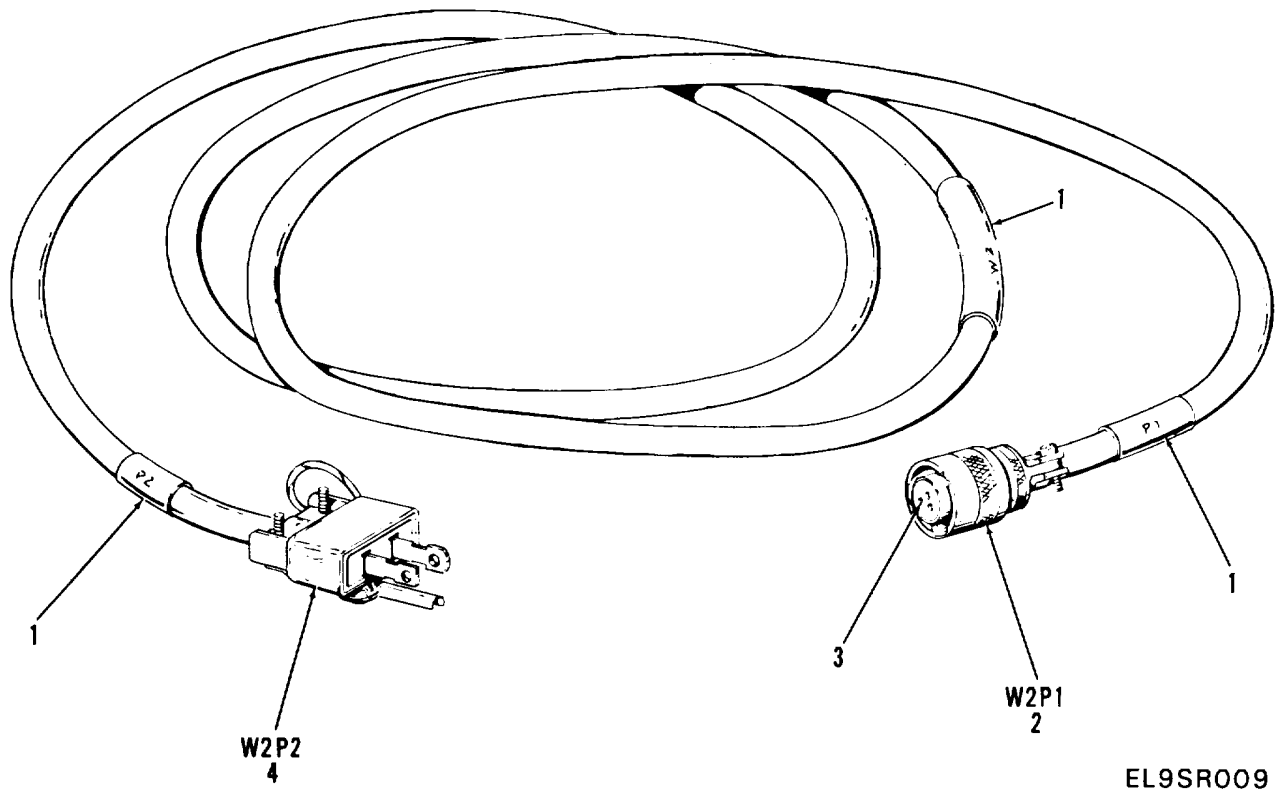

Figure 7. Power Cable Assembly W2

SECTION II

TM 11-5895-1194-24P-3

(1) ITEM NO	(2) SMR CODE	(3) CAGEC	(4) PART NUMBER	(5) DESCRIPTION AND USABLE ON CODES (UOC)	(6) QTY
-------------------	--------------------	--------------	-----------------------	--	------------

GROUP 03 POWER CABLE ASSEMBLY

W2

FIG. 7

1	PADZZ	81349	M23053/5-108-4	INSULATION SLEEVING .....	V
2	PADZZ	96906	MS3126F12-3SN	CONNECTOR, PLUG,ELEC .....	1
3	PADZZ	96906	MS3193-16-16A	CONTACT,ELECTRICAL .....	3
4	PADZZ	81348	W-C-596/13-3	CONNECTOR,PLUG,ELEC .....	1

END OF FIGURE



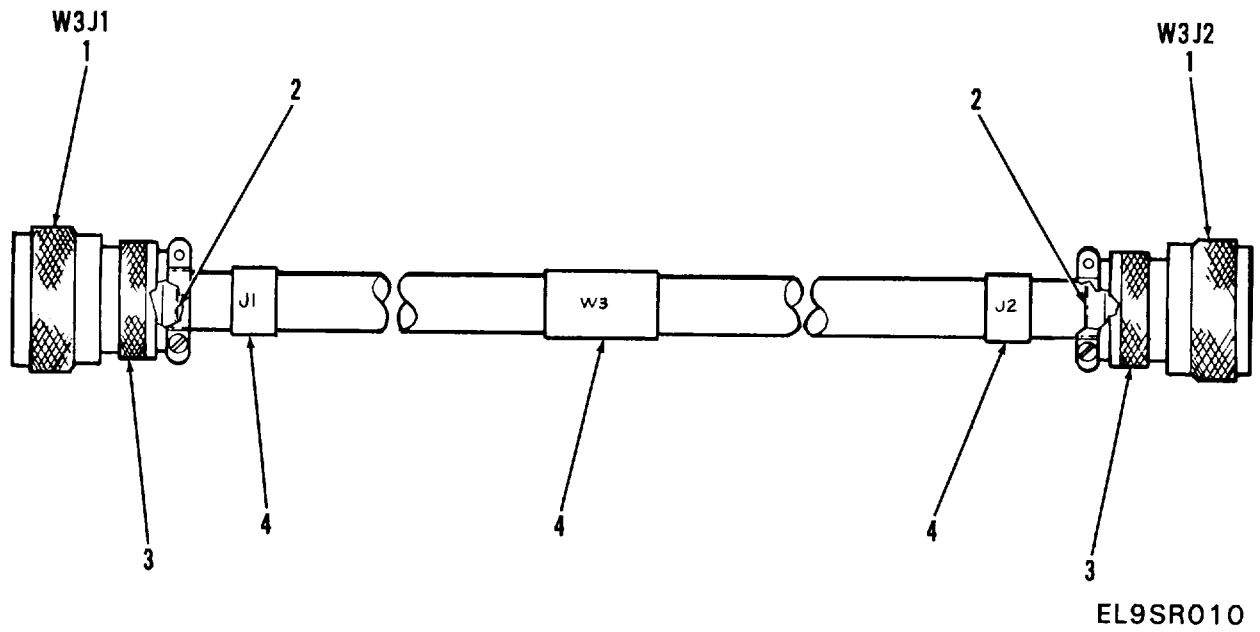

Figure 8. IST/PPX-3( ) Cable Assembly W3

## SECTION II

TM 11-5895-1194-24P-3

(1) ITEM NO	(2) SMR CODE	(3) CAGEC	(4) PART NUMBER	(5) DESCRIPTION AND USABLE ON CODES (UOC)	(6) QTY
-------------------	--------------------	--------------	-----------------------	--	------------

GROUP 04 IST/PPX-3( ) CABLE  
ASSEMBLY W3  
FIG. 8

1	PADZZ	98278	MDG3-06E15-61P-N	CONNECTOR.....	2
2	PADZZ	96906	MS3420-6	BUSHING,RUBBER.....	2
3	PADZZ	98278	086-0177-OON1	CONNECTOR,BACKSHELL.....	2
4	PADZZ	81349	M2303/5-108-3	INSULATION SLEEVING ..... V	
END OF FIGURE					

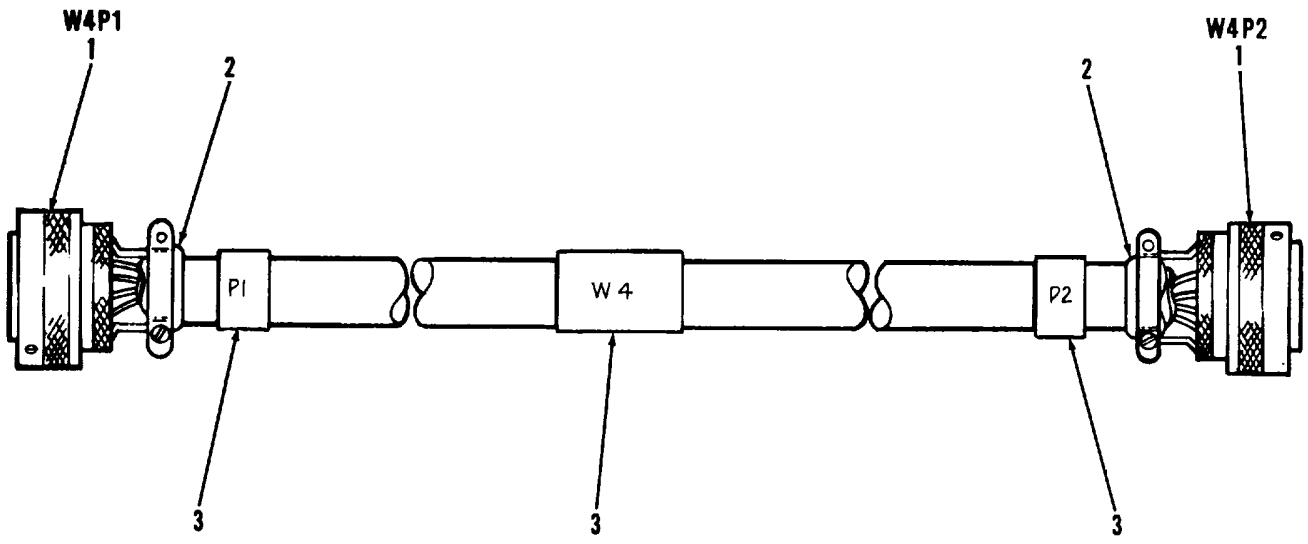

EL9SR011

Figure 9. IST/GSX-1( ) Cable Assembly W4

SECTION II

TM 11-5895-1194-24P-3

(1) ITEM NO	(2) SMR CODE	(3) CAGEC	(4) PART NUMBER	(5) DESCRIPTION AND USABLE ON CODES (UOC)	(6) QTY
-------------------	--------------------	--------------	-----------------------	--	------------

GROUP 05 IST/GSX-1 C ) CABLE  
ASSEMBLY W4  
FIG. 9

1	PADZZ	09942	BT06AC18-32SW	CONNECTOR,PLUG,ELEC .....	2
2	PADZZ	96906	M53420-6	BUSHING,RUBBER .....	2
3	PADZZ	81349	M23053/5-108-3	INSULATION SLEEVING .....	V

END OF FIGURE

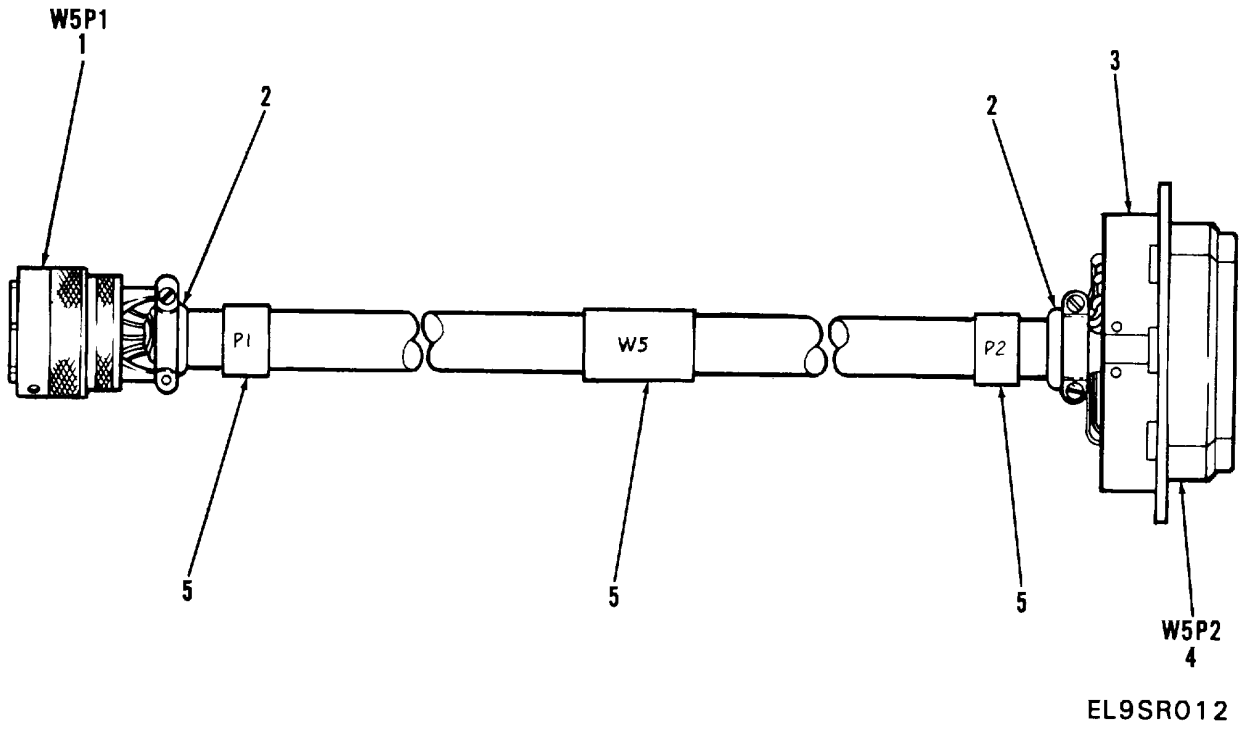

Figure 10. IST/APX-72 Cable Assembly W5

## SECTION II

TM 11-5895-1194-24P-3

(1) ITEM NO	(2) SMR CODE	(3) CAGEC CAGEC	(4) PART NUMBER	(5) DESCRIPTION AND USABLE ON CODES (UOC)	(6) QTY
-------------------	--------------------	-----------------------	-----------------------	--	------------

GROUP 06 IST/APX-72 CABLE  
ASSEMBLY WS  
FIG. 10

1	PADZZ	96906	MS3126E18-32PX	CONNECTOR,PLUG,ELEC.....	1
2	PADZZ	96906	M53420-6	BUSHING,RUBBER .....	2
3	PADZZ	71468	DPJ22039-1	SHIELD,ELECTRICAL C .....	1
4	PADZZ	71468	DPJ59C10-34SB	CONNECTOR,RECEPTACL .....	1
5	PADZZ	81349	M23053/5-108-3	INSULATION SLEEVING .....	V

END OF FIGURE

10-1

**CROSS- REFERENCE-INDEXES  
NATIONAL STOCK NUMBER INDEX**

<b>STOCK NUMBER</b>	<b>FIG.</b>	<b>ITEM</b>	<b>STOCK NUMBER</b>	<b>FIG.</b>	<b>ITEM</b>
5910-00-010-8485	3	1	5310-00-934-9759	1	23
5910-00-010-8717	4	2	5310-00-934-9761	1	19
5305-00-054-5636	2	27	5970-00-983-8046	6	3
5305-00-054-5647	2	35		8	4
5305-00-054-5648	4	23		9	3
5305-00-054-6653	2	29		10	5
5305-00-054-6654	1	13	5340-01-004-6193	2	39
5305-00-054-6670	1	10	5935-01-005-3579	7	4
5305-00-056-9962	2	38	6210-01-018-2015	2	4
5310-00-057-0573	4	24	5935-01-018-4570	2	10
5999-00-067-8663	7	3	5962-01-022-6717	3	6
5905-00-104-8337	4	5		4	16
5905-00-106-1278	4	6	5355-01-026-6940	2	1
5905-00-106-1356	2	13	5935-01-035-0998	2	7
5905-00-111-6008	2	21	5925-01-037-3324	2	3
5910-00-113-5284	4	1	5895-01-044-0343	1	2
5905-00-116-8554	2	14	5962-01-046-4552	4	11
5905-00-127-9399	2	20	5962-01-063-1966	4	19
5905-00-135-6046	4	7	5962-01-066-8394	3	8
5905-00-141-0744	4	10	5305-01-070-9615	1	8
5905-00-153-0255	4	8	6625-01-086-0248	1	17
5905-00-195-4074	3	3	5962-01-093-3309	4	17
5910-00-254-2410	4	3	5930-01-098-3242	5	7
5905-00-403-8837	3	4	5905-01-125-2399	3	11
5905-00-435-1718	4	9	5962-01-138-1656	3	9
5935-00-583-2297	2	37	5962-01-140-4130	3	5
5310-00-595-6211	2	36		4	14
5310-00-595-6761	2	25	5930-01-144-9816	5	5
5935-00-716-6979	10	3	6130-01-151-9363	1	12
5935-00-721-2862	1	15	5935-01-166-7657	3	13
5310-00-722-5998	1	14		4	27
	2	28	5965-01-190-6831	2	19
5305-00-781-5666	2	2	5935-01-190-7058	2	8
5365-00-820-4535	6	6	6625-01-201-7386	2	32
	8	2	6625-01-201-7387	2	31
	9	2	6625-01-201-7388	2	34
	10	2			
5935-00-835-0510	2	9			
5935-00-838-3695	2	5			
5935-00-841-3386	10	4			
5310-00-880-5978	1	11			
5930-00-902-2395	2	15			
	5	4			
5935-00-926-2933	10	1			
5310-00-928-2690	2	26			
5310-00-929-6395	1	18			
5310-00-933-8118	2	23			
	4	25			
5310-00-934-9748	2	24			
	4	26			

**NATIONAL STOCK NUMBER AND PART NUMBER INDEX  
PART NUMBER INDEX**

FSCM	PART NUMBER	STOCK NUMBER	FIG.	ITEM
09942	BT06AC18-32SW		9	1
54407	B15-1.5	6625-01-086-0248	1	17
02735	CD4001BF/3		3	7
02735	CD4011BD/3		4	15
02735	CD4013BF		4	20
02735	CD4024BF	5962-01-063-1966	4	19
02735	CD4050BF/3	5962-01-140-4130	3	5
			4	14
02735	CD4071BF	5962-01-093-3309	4	17
02735	CD4098BF3	5962-01-138-1656	3	9
44655	CU1011-100		2	18
71468	DPJ22039-1	5935-00-716-6979	10	3
71468	DPJ59C10-34SB	5935-00-841-3386	10	4
15737	FD110		4	13
54407	HE28-6	6130-01-151-9363	1	12
27014	LM317		4	12
04713	MC14514B		4	18
04713	MC7812CT	5962-01-046-4552	4	11
98278	MDG3-06E15-61P-N		8	1
91637	MDP1601-105G		4	21
91637	MDP1603-681G		3	12
			4	22
98278	MD63-OE1561SN869		2	6
18876	MIS-23393-007	5935-01-190-7058	2	8
18876	MIS-23408	5965-01-190-6831	2	19
96906	MS15795-802	5310-00-595-6761	2	25
96906	MS15795-803	5310-00-595-6211	2	36
96906	MS515795-805	5310-00-722-5998	1	14
			2	28
96906	MS15795-807	5310-00-880-5978	1	11
96906	MS24693-272B	5305-01-070-9615	1	8
96906	M524693C278	5305-00-781-5666	2	2
96906	MS24693C47	5305-00-056-9962	2	38
96906	MS3124E12-3P	5935-00-838-3695	2	5
96906	MS3126E18-32PN		6	1
96906	MS3126E18-32PX	5935-00-926-2933	10	1
96906	MS3126F12-3SN		7	2
96906	MS3193-16-16A	5999-00-067-8663	7	3
96906	MS3420-6	5365-00-820-4535	6	6
			8	2
			9	2
			10	2
96906	MS3474L18-32PW	5935-01-035-0998	2	7
96906	MS35338-134	5310-00-928-2690	2	26
96906	MS35338-135	5310-00-933-8118	2	23
			4	25
96906	MS35338-136	5310-00-929-6395	1	18
96906	MS35338-137		1	24
96906	MS35649-244	5310-00-934-9748	2	24
			4	26
96906	MS35649-264	5310-00-934-9761	1	19



**NATIONAL STOCK NUMBER AND PART NUMBER INDEX  
PART NUMBER INDEX**

FSCM	PART NUMBER	STOCK NUMBER	FIG.	ITEM
96906	M535649-284	5310-00-934-9759	1	23
96906	MS51957-13	5305-00-054-5647	2	35
96906	M551957-14	5305-00-054-5648	4	23
96906	MS51957-2	5305-00-054-5636	2	27
96906	M551957-29	5305-00-054-6653	2	29
96906	M551957-30	5305-00-054-6654	1	13
96906	M551957-45	5305-00-054-6670	1	10
96906	M551957-46		1	21
96906	M575028-23	5930-00-902-2395	2	15
			5	4
96906	MS91528-1U2B	5355-01-026-6940	2	1
81349	M23053/5-108-3	5970-00-983-8046	6	3
			8	4
			9	3
			10	5
81349	M23053/5-108-4		7	1
81349	M38510/05503BEB	5962-01-022-6717	3	6
			4	16
81349	M38510/17001BCB		3	10
81349	M39012/19-0502	5935-01-018-4570	2	10
81349	M39012/21-0001	5935-00-835-0510	2	9
81349	M39014/01-1324	5910-00-010-8485	3	1
81349	M39014/01-1580	5910-00-254-2410	4	3
81349	M39014/01-1593	5910-00-010-8717	4	2
81349	M39014/02-1358	5910-00-113-5284	4	1
81349	M39019/01-248	5925-01-037-3324	2	3
81349	M8340102K1004GB	5905-01-125-2399	3	11
81349	M83731/7-261	5930-01-144-9816	5	5
80205	NAS620C4	5310-00-057-0573	4	24
81349	RCR05G105JS	5905-00-195-4074	3	3
81349	RCR05G223JS	5905-00-403-8837	3	4
81349	RCR07G105JS	5905-00-116-8554	2	14
81349	RCR07G123JS	5905-00-106-1278	4	6
81349	RCR07G152JS	5905-00-106-1356	2	13
81349	RCR07G241JS	5905-00-435-1718	4	9
81349	RCR07G562JS	5905-00-141-0744	4	10
81349	RCR07G681JS	5905-00-135-6046	4	7
81349	RCR20G751JS	5905-00-104-8337	4	5
81349	RCR32G390JS	5905-00-127-9399	2	20
81349	RCR32G6R8JS	5905-00-111-6008	2	21
81349	RNR55C2551FS	5905-00-153-0255	4	8
81349	RWR8951ROOFS		5	3
11627	SCD 11337	5962-01-066-8394	3	8
81348	W-C-596/13-3	5935-01-005-3579	7	4
98291	016-2008		2	16
98278	086-0177-o0N1		8	3
00779	102154-1		5	2
00779	102160-1		3	2
			4	4
00779	102185-2	5935-01-166-7657	3	13
			4	27

**NATIONAL STOCK NUMBER AND PART NUMBER INDEX  
PART NUMBER INDEX**

<b>FSCM</b>	<b>PART NUMBER</b>	<b>STOCK NUMBER</b>	<b>FIG.</b>	<b>ITEM</b>
74970	111-0742-002		2	11
74970	111-0743-002		2	12
18876	11509861	5895-01-044-0343	1	2
02660	126-220	5935-00-583-2297	2	37
02660	126-221	5935-00-721-2862	1	15
06540	13213-55-0832		2	41
45413	154273		6	5
45413	154279		6	4
45413	156127		2	33
45413	156187		1	9
45413	156242		2	30
45413	156402		1	20
45413	156403		2	22
45413	156404		1	6
45413	156405		1	22
45413	156406		2	49
45413	156412		1	7
45413	156483	6625-01-201-7386	2	32
45413	156484	6625-01-201-7387	2	31
45413	156485	6625-01-201-7388	2	34
45413	156602		3	14
45413	156603		4	28
45413	156604		5	8
45413	157119		1	1
45413	157120		1	5
45413	157121		1	3
45413	157122		1	4
45413	157420		1	6
76854	399049-AM		5	6
76854	399053-AM	5930-01-098-3242	5	7
76854	399287-AM		2	17
79963	5014-097-11		6	2
72619	559-0101-001	6210-01-018-2015	2	4
72619	561-0101-100		5	1
06540	8161-SS-0440	5340-01-004-6193	2	39

By Order of the Secretary of the Army:

JOHN A. WICKHAM JR.  
*General, United States Army*  
*Chief of Staff*

Official:

DONALD J. DELANDRO  
*Brigadier General, United States Army*  
*The Adjutant General*

DISTRIBUTION:

To be distributed in accordance with DA Form 12-32 literature requirements for STINGER.

\* U.S. GOVERNMENT PRINTING OFFICE:1985-515-085-20149

RECOMMENDED CHANGES TO EQUIPMENT TECHNICAL PUBLICATIONS



THEN...JOT DOWN THE  
DOPE ABOUT IT ON THIS FORM.  
CAREFULLY TEAR IT OUT, FOLD IT  
AND DROP IT IN THE MAIL.

SOMETHING WRONG WITH PUBLICATION

FROM: (PRINT YOUR UNIT'S COMPLETE ADDRESS)

DATE SENT

PUBLICATION NUMBER

PUBLICATION DATE

PUBLICATION TITLE

BE EXACT PIN-POINT WHERE IT IS

PAGE  
NO.

PARA-  
GRAPH

FIGURE  
NO.

TABLE  
NO.

IN THIS SPACE, TELL WHAT IS WRONG  
AND WHAT SHOULD BE DONE ABOUT IT.

TEAR ALONG PERFORATED LINE

PRINTED NAME, GRADE OR TITLE AND TELEPHONE NUMBER

SIGN HERE

